

Coastal Elementary School Morning Drop Off Procedures

Morning Pick Up Step-by-Step Directions

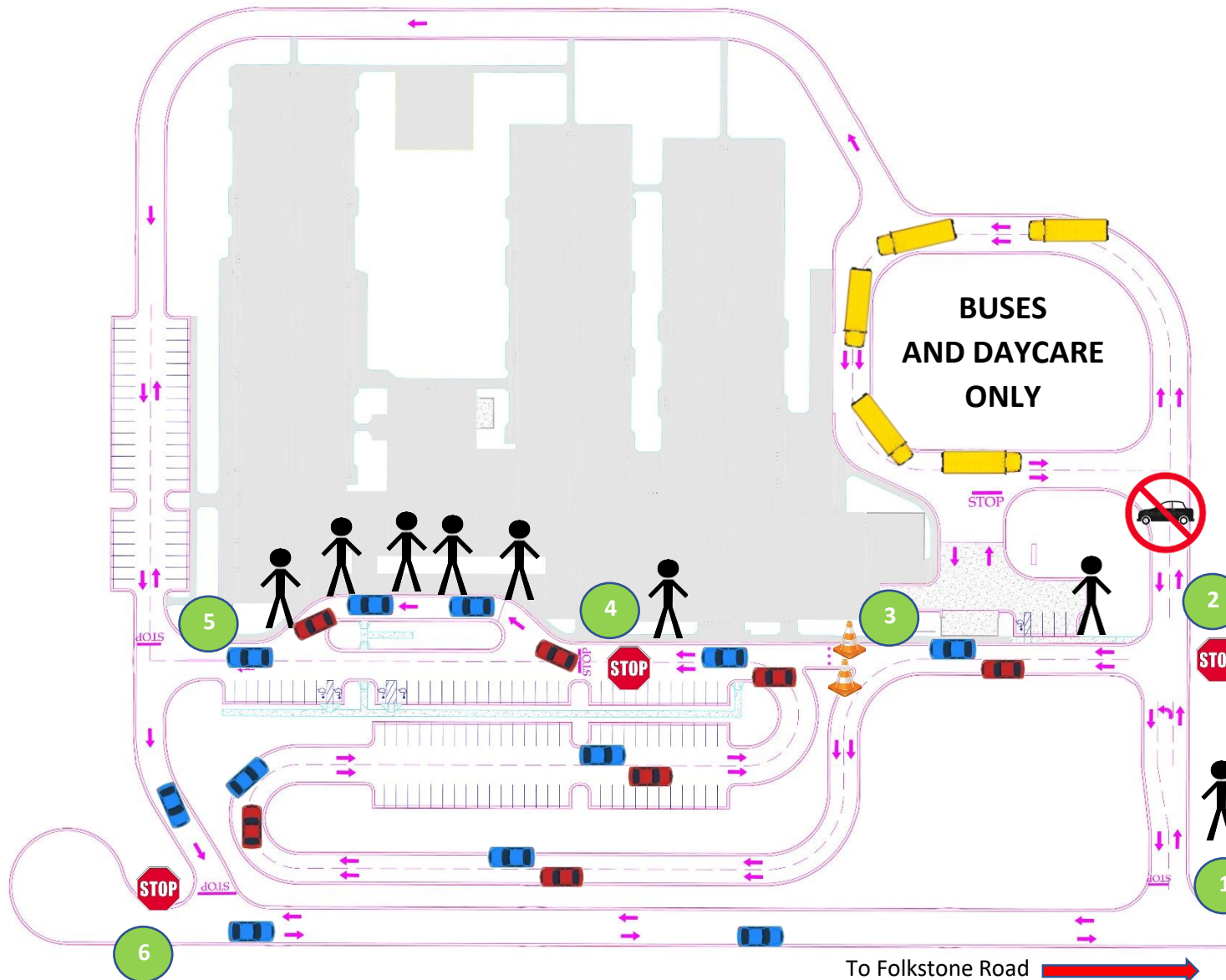

- The campus-wide speed limit is 15mph. Please use extreme caution.
- When entering campus for drop off, you will turn right at #1 on the map. You may be asked to stop at #1 by a staff member if cars are backed up to #2.
- Stop at #2. You will proceed to turn left at #2 once buses have passed by. Please note that cars are not allowed to drive forward to the bus lot.
- At #2, cars should begin to “double-stack” (one car in each lane – see map).
- At #3, you will be directed to drive to the left. Cones will block you from continuing forward to the drop off area.
- Continue through the driveway, double-stacked, until you reach #4. A staff member will be stationed at #4 and will stop you.
- Once you reach the front of the line at #4, the assigned staff member will direct one car from each lane to move forward until 7-8 cars are stopped and ready to unload.
- Staff members will assist students out of cars and into the building.
- At #5, please slowly pull away from the drop-off zone. Traffic is one-way.
- Stop at #6. Turn left when traffic is clear. Traffic becomes two-way. Drive to the exit and stop sign on Folkstone Rd.
- Maintain 15mph campus-wide speed limit until you exit campus.

Please be patient and use extreme caution while driving on campus during arrival and dismissal. We anticipate the first week or two of arrival to be hectic as we work through logistics. The campus-wide speed limit is 15mph.